

REV	ECN	DESCRIPTION	APP'D
1			

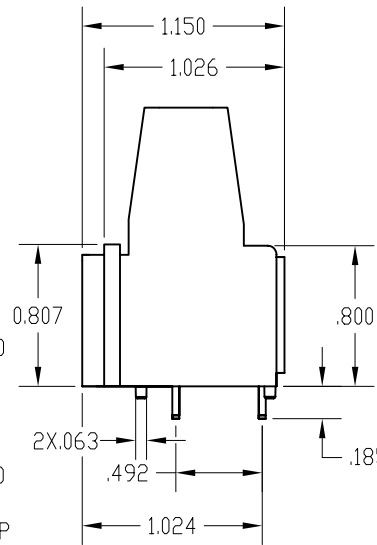

PRINTED CIRCUIT BOARD CONFIGURATION

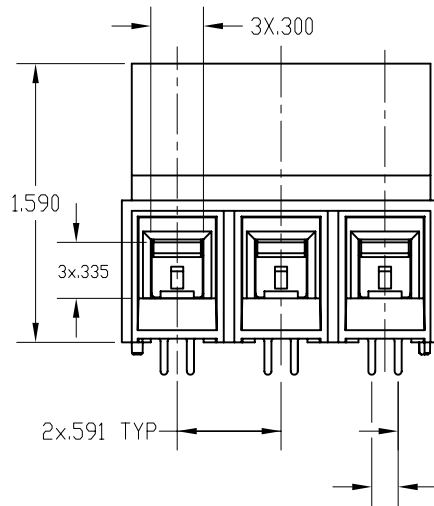
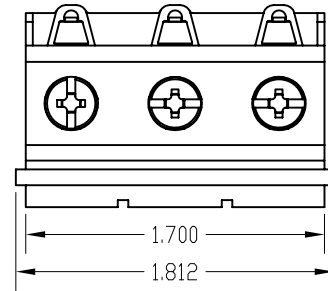
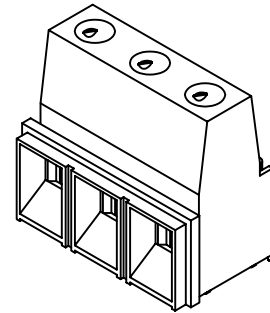
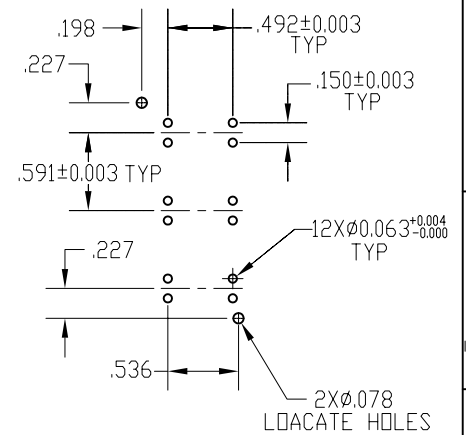

RECOMMENDED PCB THICKNESS:
0.062±0.008

UL
PATINGS
CURRENT-75A PENDING
VOLTAGE-300V PENDING
U.L. FILE NO. E83421



CSA
PATINGS
CURRENT-75A PENDING
VOLTAGE-PENDING
CSA FILE NO:LR69703

DIN VDE 0627:1986
DIN VDE 0110-1:1989
EN 60947-1:1991
EN 60947-7-1:1992
CURRENT-75A PENDING
VOLTAGE- PENDING
TUV FILE NO. 20396

INSTALLATION
RECOMMENDATIONS:

WIRE RANGE: AWG#4-16AWG, STD OR SOLID
WIRE STRIP LENGTH: 0.630"(16.0MM)
TIGHTENING TORQUE: 20LB-IN.

MATERIAL:

HOUSING: PA,UL94V-0,BLACK
CONTACT: COPPER ALLOY, TIN PLATING PER ASTM B-545
SCREW: STEEL,ZINE PLATING PER ASTM B63398
WIRE CLAMP: STEEL ZINE PLATING PER ASTM B63398
OPERATING TEMPERATURE: -40°-120°

DIMENSIONS	TOLERANCES	PROJECTION	TITLE	
ANSI Y14.5M UNITS: INCHES Pro/E FILE	.XX ±.001 .XXX ±.0001 ANGLES ±05°		Amphenol Pcd SPECIFICATION DRAWING	
DRWN	ENGR	APPD	SIZE A	DWG NO. ELMP03051_C
DRIGINAL	THIS DOCUMENT CONTAINS PROPRIETARY INFORMATION WHICH IS THE CONFIDENTIAL PROPERTY OF AMPHENOL PCD, BEVERLY, MA	APPD	CODE: 58982	SCALE: NONE
			SHEET 1	REV 1

ELMP03051_C

ELMP03051_C